

ZONE	REV	DESCRIPTION	DATE	DESIGNED BY	APPROVED BY

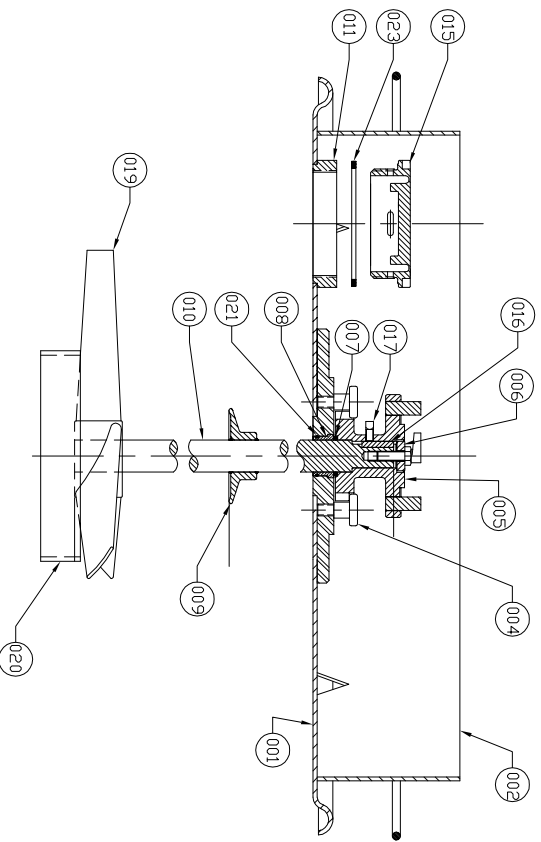
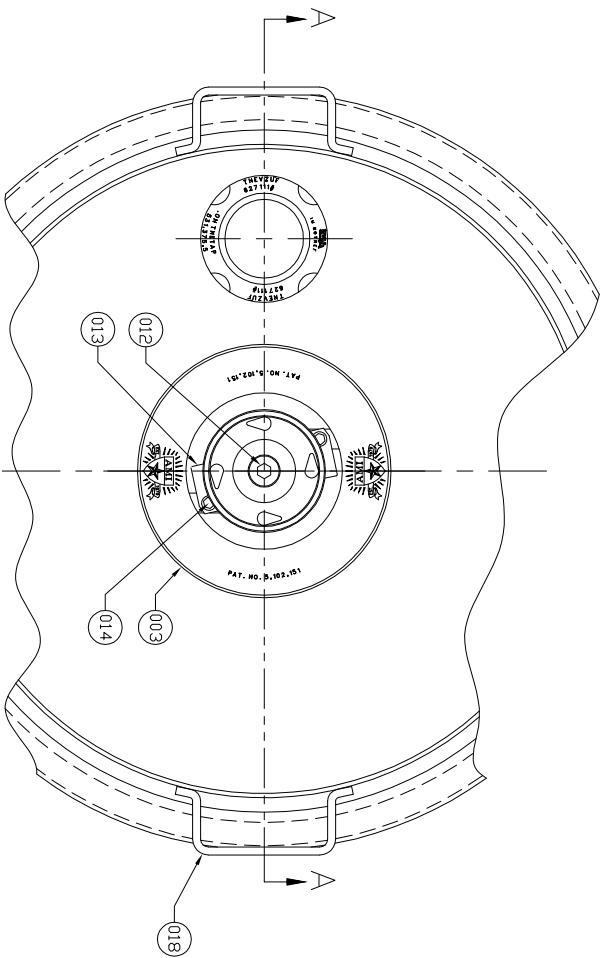

PARTIAL SECTION: A-A

DETAIL	QTY.	PART NO.	DESCRIPTION
001	1	112517	COVER
002	1	110137	GUARD
003	1	114441	FLANGE
004	2	110049	PIN
005	1	110066	COUPLING
006	1	110036	WASHER
007	1	110067	O-RING
008	1	114439	BEARING
009	1	110008	SLING
010	1	110292	SHAFT
011	1	111727	FLANGE
012	1	112147	SCREW
013	2	110035	LUG
014	2	110034	SCREW
015	1	111726	VENT
016	1	110102	KEY
017	1	110101	SCREW
018	2	110193	HANDLE
019	1	110929	IMPELLER
020	1	110999	RING
021	1	114438	O-RING
023	1	113847	GASKET

UNLESS OTHERWISE SPECIFIED
DIMENSIONS ARE IN INCHES

FRACTIONS: .XX	DECIMALS: .XXX	ANGLES: ± 1°
± 1/16	± .010	± .001

THIS DRAWING HAS BEEN FINISHED BY AMERICAN MACHINING, INC. THE INFORMATION AND KNOW-HOW CONTAINED HEREIN IS THE PROPERTY OF AMERICAN MACHINING, INC. AND IS NOT TO BE REPRODUCED OR TRANSMITTED IN ANY FORM OR BY ANY MEANS, ELECTRONIC OR MECHANICAL, INCLUDING PHOTOCOPYING, RECORDING, OR BY ANY INFORMATION STORAGE AND RETRIEVAL SYSTEM, WITHOUT THE WRITTEN PERMISSION OF AMERICAN MACHINING, INC. REPRODUCTIONS IN WHICH OR IN PART INCLUDING VENDOR SHOP DRAWINGS, SHALL BEAR OR REFER TO THIS NOTE.

FINISH: FINE
DRAWN BY: _____
CHECKED BY: _____
N/A ✓

PRODUCTION: DO NOT SCALE THIS DRAWING
BREAK SHARP EDGES
REMOVE BURRS & FLASH

DESCRIPTION: MIXER COVER ASSEMBLY
293 GALLON TANK
PART NUMBER: MCAST15-WEB
REV: -

APPROVED BY: _____ DATE: _____ SCALE: 1/4 MAT'L: SEE DETAILS SHEET 1 OF 1